

Surge arresters

MCL-OPW

Application:

Medium voltage surge arresters are offered in two versions: for indoor and outdoor use. Surge arresters are made of strictly connected varistors, separated from the cover by a special resin dilatation.

Products comply with the standard PN-EN 60099-4: 2009.

Basic features:

- › outdoor and indoor use
- › high resistance to dirt
- › excellent hydrophobic properties in outdoor performance
- › maintenance-free
- › low weight and small dimensions
- › mounting system and the power supply is unified with post insulators



Operating conditions:

AMBIENT TEMPERATURE	-40°C up to +40°C
MAX. HEIGHT	up to 1000 m above sea level
MAX. CROSS-SECTION OF THE CONNECTION LINE	up to 70 mm ²

Versions:

INDOOR	housing made of epoxy resin, red color
OUTDOOR	housing made of hydrophobic epoxy composites
CLAMPS, BOLTS, NUTS	made of chrome-nickel steel
MAX. CROSS-SECTION OF THE CONNECTION LINE	up to 70 mm ²
FREQUENCY	48 Hz - 62 Hz

Technical data:

	MCL-OPW / 01	MCL-OPW / 02	MCL-OPW / 03	MCL-OPW / 04	MCL-OPW / 05	MCL-OPW / 06	MCL-OPW / 07	MCL-OPW / 08	MCL-OPW / 09	MCL-OPW / 10	MCL-OPW / 11
Rated voltage U_r	3	6	9	12	15	18	21	24	27	30	33
Continuous operating voltage U_c	2,4	4,8	7,2	9,6	12	14,4	16,8	19,2	21,6	24	26,4
Lower voltage at rated discharge current u_o not higher than	7,7	15,4	23,1	30,8	38,5	46,2	53,9	61,6	69,3	77	84,7
Lowered voltage at current impulse 10 kA 1/3	9,4	18,8	28,2	37,6	47,1	56,5	65,6	75,3	84,7	94,1	103,5
Reduced connecting voltage 250 A	6,3	12,7	19	25,4	31,7	38,1	44,4	50,8	57,1	63,4	69,8
Creeping path [mm]	~ 60	~ 110	~ 180		~ 245		~ 290			~ 490	
Height [mm]	64	99	134		179		214			304	

PARAMETER	VALUE
Rated voltage U_r	3 kV up to 33 kV
Rated discharged current	10 kA
Limiting discharged current	100 kA
Rectangular impulse current withstand	(2000 μ s) 250 A
Line discharge class	1
Energy absorption capability	2,8 kJ/kV U_c 3,22 kJ/kV U_r

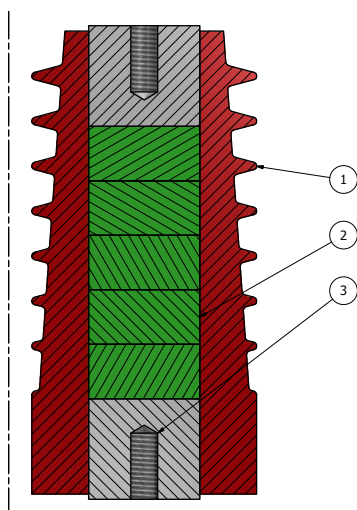

Marking:

- › 1: epoxy resin
- › 2: varistors
- › 3: aluminum ferrule

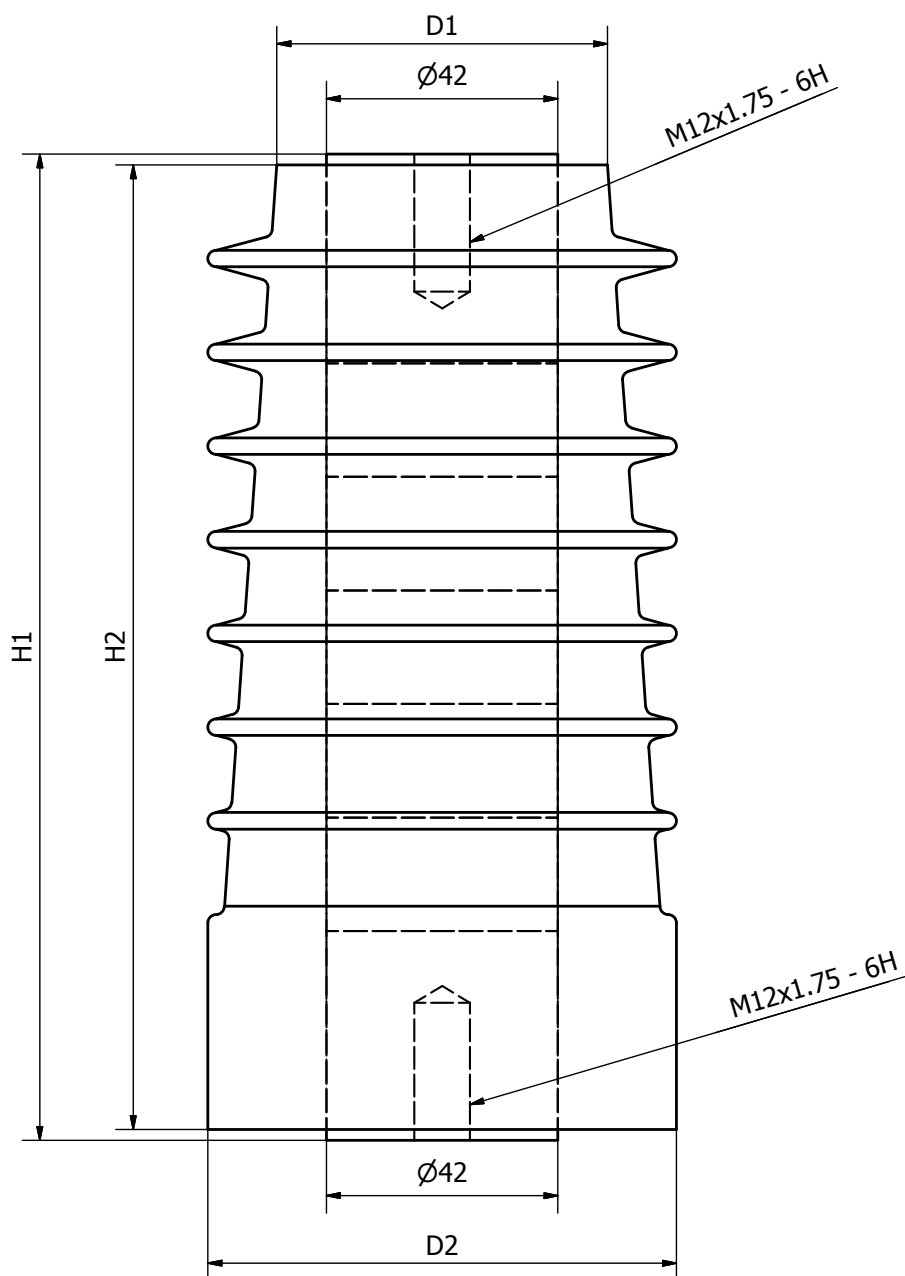

	MCL-OPW / 01	MCL-OPW / 02	MCL-OPW / 03	MCL-OPW / 04	MCL-OPW / 05	MCL-OPW / 06	MCL-OPW / 07	MCL-OPW / 08	MCL-OPW / 09	MCL-OPW / 10	MCL-OPW / 11
H1	64	99	134		179		214			304	
H2	60	95	130		175		210			300	
D1	Φ 60	Φ 60	Φ 55		Φ 60		Φ 60			Φ 75	
D2	Φ 60	Φ 60	Φ 75		Φ 85		Φ 90			Φ 114	